

| REVISION | | DESCRIPTION |
|----------|------------|-------------|
| REV | DATE | Value |
| A | 12/22/2006 | |

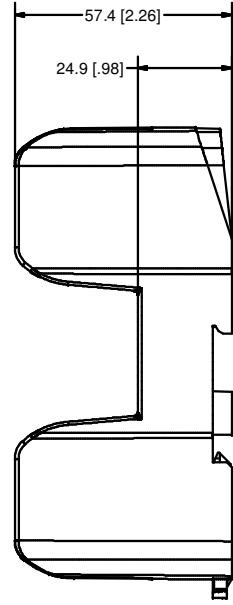
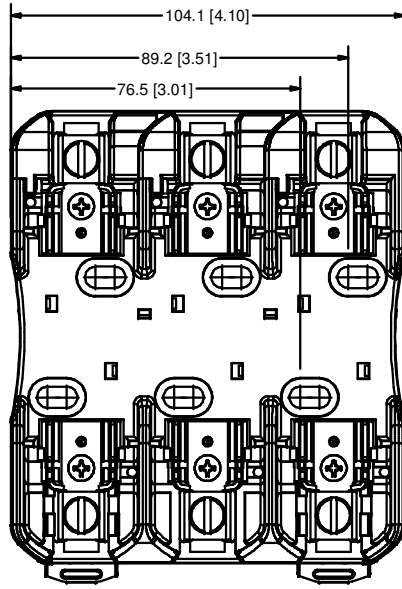
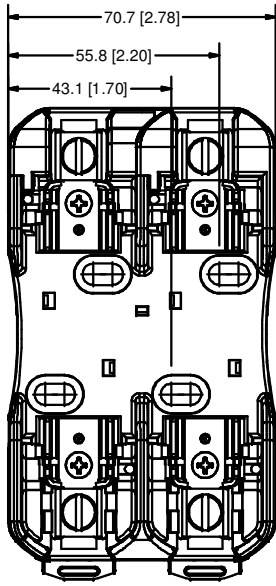
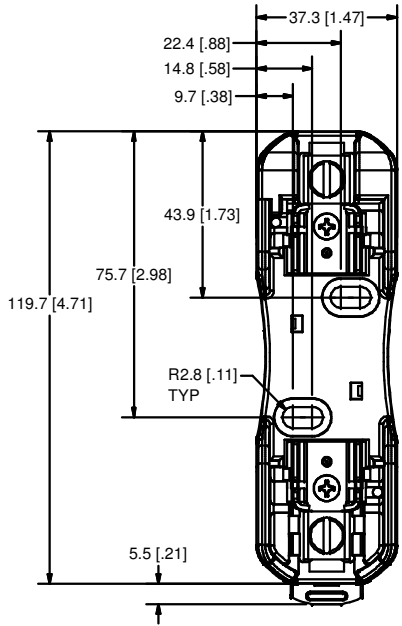

SPECIFICATIONS:

VOLTAGE RATING: 250V

AMPERE RATING: 60 AMPERES

INTERRUPT RATING: 10kA

TERMINAL TYPE: BOX LUG

SUGGESTED TORQUE: 5.6 N-m (50 IN-LBS) 2-4 AWG
2.8 N-m (25 IN-LBS) 6-14 AWG

WIRE RANGE: 2-14 AWG Cu/Al
SOLID/STRANDED

APPROVALS: UL LISTED (FILE NO. E14721)
CSA CERTIFIED (FILE NO. LR73091)

| | | | |
|-------------------------------------------------------------------------------------------------------------------------------------------------------------------------------------------------------------|--------------------------------------------------------------------------------------------------------------------------------------------------------------------------|---------------|--------------------------------|
| ● | DENOTES CRITICAL CHARACTERISTICS. | | |
| CPK | DENOTES CPK DIMENSIONS, -MINIMUM CPK VALUE | | |
| (ST) | DENOTES A CHARACTERISTIC THAT PROVIDES AN INDICATION OF PROCESS PERFORMANCE. PROCEDURE FOR MEASUREMENT AND TRACKING TO BE DEFINED IN LITTELFUSE INSPECTION INSTRUCTIONS. | | |
| CP | DENOTES CP DIMENSIONS, -MINIMUM CP VALUE MUST BE WITHIN THE DIMENSIONAL LIMITATIONS SHOWN ON DRAWING AND INITIALLY LOCATED TO ALLOW FOR MAXIMUM TOOL LIFE. | | |
| MATL SPEC | | FINISH | |
| DRW M. York | DATE 2/9/2010 | SCALE NTS | FINISH GOOD WT GRAMS/PIECE |
| UNLESS OTHERWISE SPECIFIED, DIMENSIONS ARE IN MILLIMETERS, DIMENSIONS IN BRACKETS [] ARE INCHES DIMENSIONING AND DO NOT INCLUDE PLATING. TOLERANCING TO BE INTERPRETED IN ACCORDANCE WITH ANSI Y14.5M-1994 | | | |
| 3RD ANGLE PROJECTION | | | |
| TITLE | LFH25060 OUTLINE | | |
| Littelfuse® DES PLAINES, ILLINOIS 60016 | | REVISION A | DRWG NO. OL-LFH25060 Series |