

REVISION		
REV	DATE	DESCRIPTION
A	7/26/23	526751GCP - RELEASE MRY

$\varnothing 10.3 \pm 0.15$   
 $[\varnothing 0.406 \pm 0.006]$

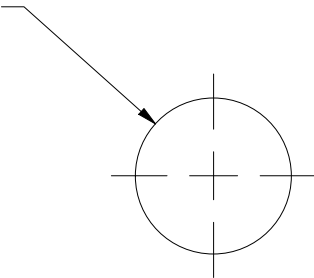

$35.8 \pm 0.762$   
 $[1.410 \pm 0.030]$

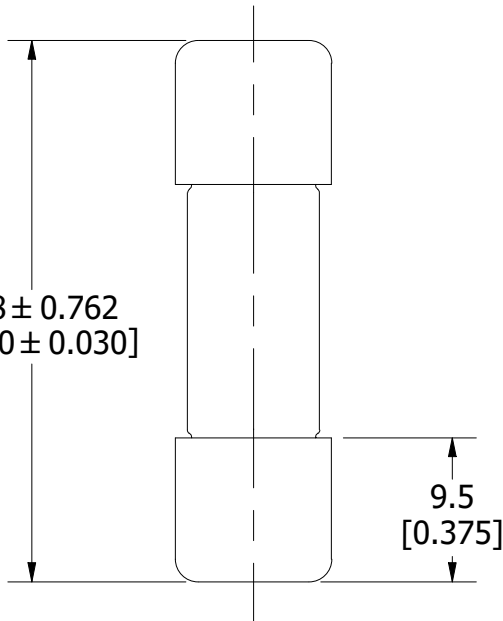

9.5  
 $[0.375]$

1	COMPONENT NO	DESCRIPTION	QTY/M	U/M
<b>BILL OF MATERIAL</b>				
<S>	CRITICAL CHARACTERISTIC FOR PART SAFETY/COMPLIANCE			
●	DENOTES CRITICAL CHARACTERISTICS.			
CPK	DENOTES CPK DIMENSIONS, -MINIMUM CPK VALUE			
⊠	DENOTES A CHARACTERISTIC THAT PROVIDES AN INDICATION OF PROCESS PERFORMANCE. PROCEDURE FOR MEASUREMENT AND TRACKING TO BE DEFINED IN LITTELFUSE INSPECTION INSTRUCTIONS.			
CP	DENOTES CP DIMENSIONS, -MINIMUM CP VALUE MUST BE WITHIN THE DIMENSIONAL LIMITATIONS SHOWN ON DRAWING AND INITIALLY LOCATED TO ALLOW FOR MAXIMUM TOOL LIFE.			<b>A</b>
MATL SPEC			FINISH	
DRW JMoler	DATE 7/18/2023	SCALE NTS	FINISH GOOD WT GRAMS/PIECE	
UNLESS OTHERWISE SPECIFIED, DIMENSIONS ARE IN MILLIMETERS, DIMENSIONS IN BRACKETS [ ] ARE INCHES DIMENSIONING AND DO NOT INCLUDE PLATING. TOLERANCING TO BE INTERPRETED IN ACCORDANCE WITH ANSI Y14.5M-1994				
3RD ANGLE PROJECTION 				
<b>TITLE</b> SLC 20A OUTLINE				
 CHICAGO, ILLINOIS 60631		REVISION <b>A</b>	DRWG NO. <b>OL-OSLC020</b>	SHEET 1 OF 1