

| REVISION | | |
|----------|---------|-------------------------|
| REV | DATE | DESCRIPTION |
| A | 8/31/22 | 525635GCP - RELEASE MRY |

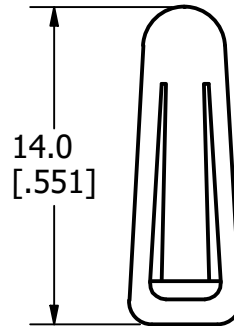
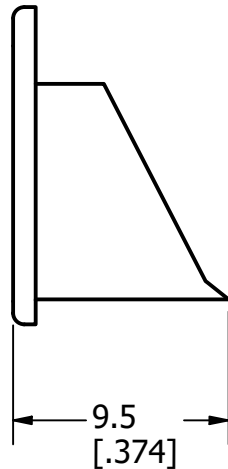
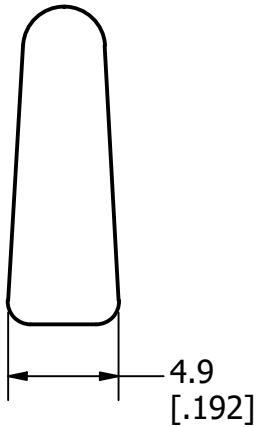
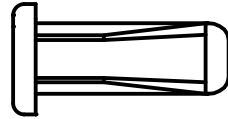

| 1 | COMPONENT NO | DESCRIPTION | QTY/M | U/M |
|---|--------------|-------------|-------|-----|
|---|--------------|-------------|-------|-----|

BILL OF MATERIAL

| | |
|-----|--|
| <S> | CRITICAL CHARACTERISTIC FOR PART SAFETY/COMPLIANCE |
| ● | DENOTES CRITICAL CHARACTERISTICS. |
| CPK | DENOTES CPK DIMENSIONS, -MINIMUM CPK VALUE |
| ⊠ | DENOTES A CHARACTERISTIC THAT PROVIDES AN INDICATION OF PROCESS PERFORMANCE. PROCEDURE FOR MEASUREMENT AND TRACKING TO BE DEFINED IN LITTELFUSE INSPECTION INSTRUCTIONS. |
| CP | DENOTES CP DIMENSIONS, -MINIMUM CP VALUE MUST BE WITHIN THE DIMENSIONAL LIMITATIONS SHOWN ON DRAWING AND INITIALLY LOCATED TO ALLOW FOR MAXIMUM TOOL LIFE. |

A

| | | | |
|---------------|-------------------|--------------|-------------------------------|
| MATL SPEC | | FINISH | |
| DRW JMOLER | DATE 8/23/2022 | SCALE NTS | FINISH GOOD WT GRAMS/PIECE |

UNLESS OTHERWISE SPECIFIED, DIMENSIONS ARE IN MILLIMETERS, DIMENSIONS IN BRACKETS [] ARE INCHES DIMENSIONING AND DO NOT INCLUDE PLATING. TOLERANCING TO BE INTERPRETED IN ACCORDANCE WITH ANSI Y14.5M-1994

| | |
|-------------------------|--|
| 3RD ANGLE PROJECTION | |
|-------------------------|--|

TITLE EDCP42 OUTLINE

| | | | |
|--|----------|-----------|--------------|
| Littelfuse CHICAGO, ILLINOIS 60631 | REVISION | DRWG NO. | SHEET 1 OF 1 |
| | A | OL-EDCP42 | |