

THIS DRAWING AND THE INFORMATION CONTAINED WITHIN IT ARE CONFIDENTIAL AND MAY NOT BE COPIED OR DISCLOSED WITHOUT THE WRITTEN PERMISSION OF LITTELFUSE.

REVISIONS				
ZONE	REV.	DESCRIPTION	DATE	APPROVED
	A	GCF 523963 NEW RELEASE	28/Jun/2021	EJIN
	B	524752ECC-LATCH PN WAS 883-088	1/20/2022	EJIN

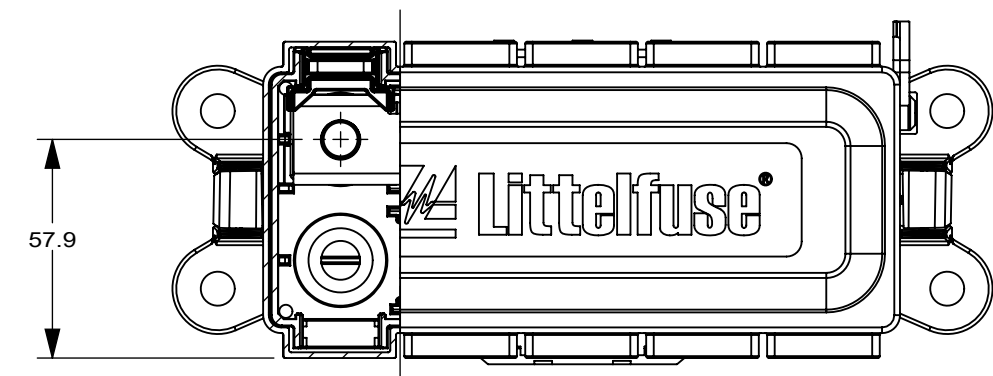

SECTION A-A

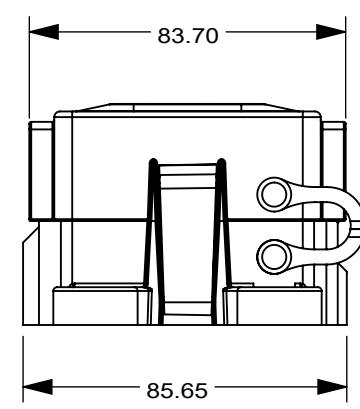
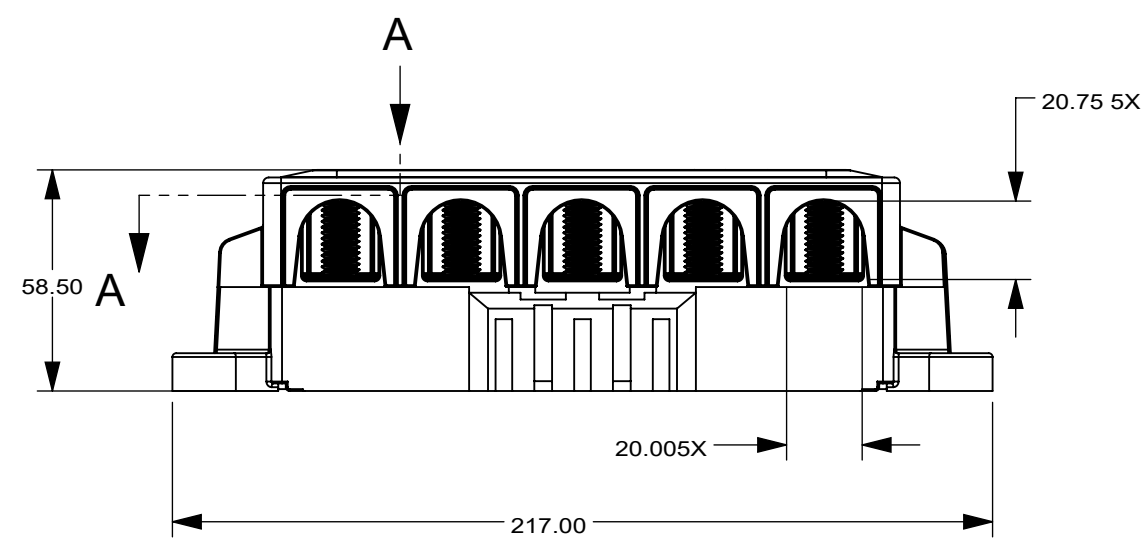
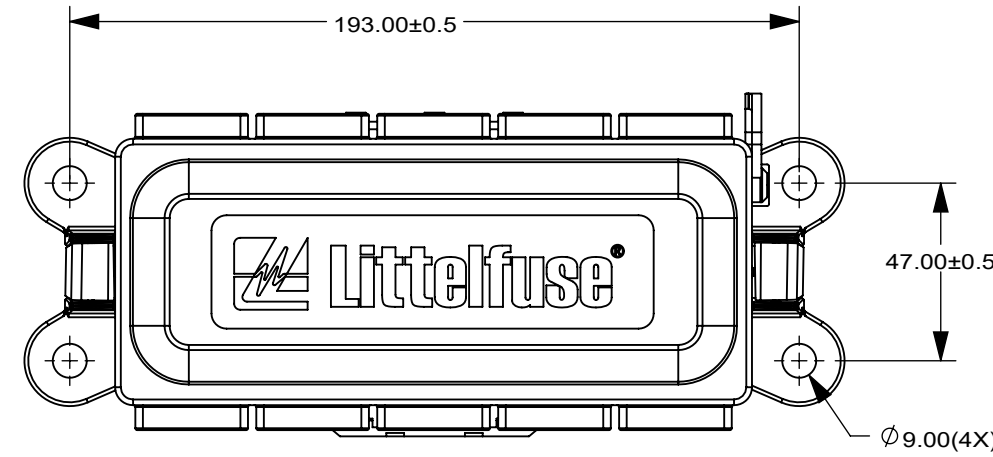
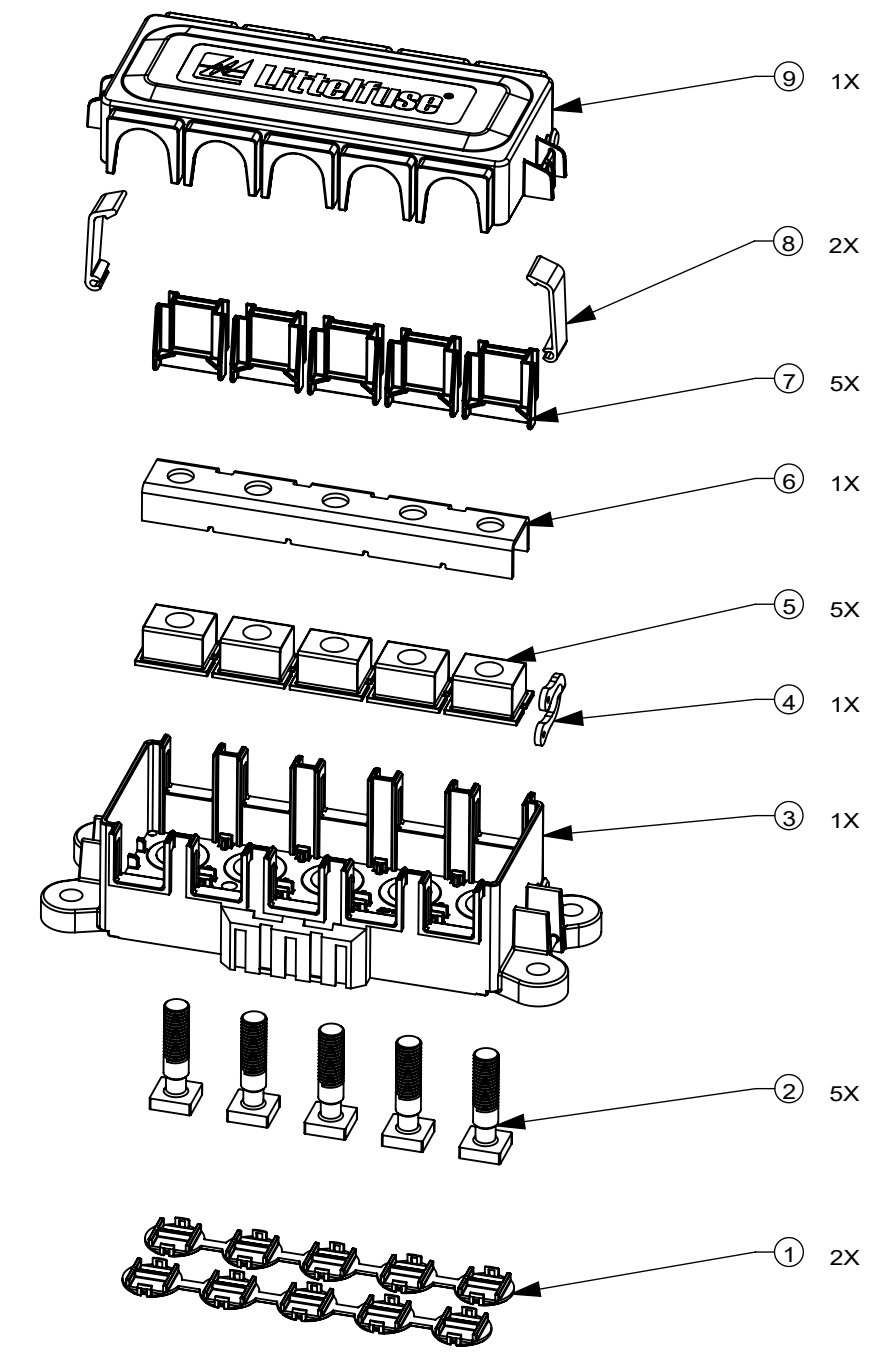
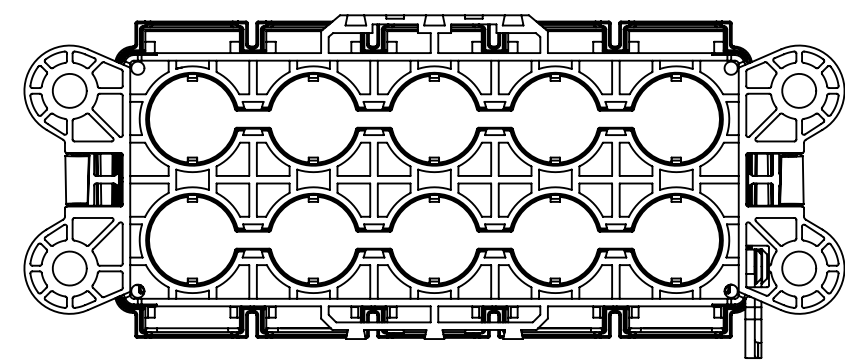

NO.	COMPONENT NO.	COMPONENT NAME	QTY/M	U/M
9	873-716	COVER	1	EA
8	(B) 883-029	LATCH	2	EA
7	901-520	DUST COVER	5	EA
6	882-927-5	U SHAPE BUS BAR	1	EA
5	901-722	SINGLE SUPPORT	5	EA
4	890009470	TETHER	1	EA
3	868-967	BASE	1	EA
2	908-077	M10 STUD	5	EA
1	883-094	BOTTOM CAP	2	EA

LIMIT DIMENSIONS OF PLASTIC MOLDED PARTS FOR NOMINAL SIZE RANGES PER ISO IN LITTELFUSE CVP-NPD20-0002, DIMENSIONS MM												
1 to 3	>3 to 6	>6 to 10	>10 to 18	>18 to 30	>30 to 50	>50 to 80	>80 to 120	>120 to 180	>180 to 250	>250 to 315	>315 to 400	ANGLE
±0.08	±0.11	±0.14	±0.17	±0.20	±0.23	±0.36	±0.50	±0.58	±0.65	±0.70	±0.78	NONE

SURFACE PROFILE DIMENSIONS OF PLASTIC MOLDED PARTS FOR NOMINAL SIZE RANGES PER ISO IN LITTELFUSE CVP-NPD20-0002, DIMENSIONS MM											
0.50	0.50	0.50	0.50	0.50	0.50	0.50	0.50	1.0	2.0	4.0	4.0

PER CHNPD20-0008 PROCEDURE	●	FIT/ FUNCTION CRITICAL CHARACTERISTICS
	<S>	SAFETY/ COMPLIANCE CRITICAL CHARACTERISTICS SYMBOL
	CPK	DENOTES CPK DIMENSIONS MINIMUM CPK VALUE
	ST	DENOTES A CHARACTERISTIC THAT PROVIDES AN INDICATION OF PROCESS PERFORMANCE PROCEDURE FOR MEASUREMENT AND TRACKING TO BE DEFINED IN LITTELFUSE INSPECTION INSTRUCTIONS
CP	DENOTES CP DIMENSIONS. MINIMUM CP VALUE MUST BE WITHIN THE DIMENSIONAL LIMITATIONS SHOWN ON DRAWING AND INITIALLY LOCATED TO ALLOW FOR MAXIMUM TOOL LIFE	

NOTES:

- MATERIALS:
 BASE/COVER: BLACK FR530
 BUS BAR: C1100 Sn PLATED
 DUST COVER: GREEN SILICON RUBBER
 TETHER: BLACK SILICON RUBBER
 STUD: STEEL Ni/Fe ALLOY PLATED
 BOTTOM CAP: BLUE PA66
 LATCH: YELLOW POM
 SUPPORT: BLACK BAKELITE
- MAX. MAIN INPUT: 400A
- OPERATING TEMPERATURE RANGE: -40°C TO 105°C
- M8 MOUNTING TORQUE: 10±2 Nm
- MAX. WIRE SIZE 105 sqmm OR AWG 4/0

DRAWN	VLI	DATE	7/7/2021	 Expertise Applied Answers Delivered
CHECKED	FYUE	DATE	7/7/2021	
FORM NO: CVP-PE40-0005 REV B				TITLE
THIRD ANGLE PROJECTION				FHZ 5-STUD GROUND BOX
		SIZE	C	DWG. NO.
DO NOT SCALE DRAWING		SCALE	1:2	FHZ1008Z
				REV. B
				SHEET 1 OF 2

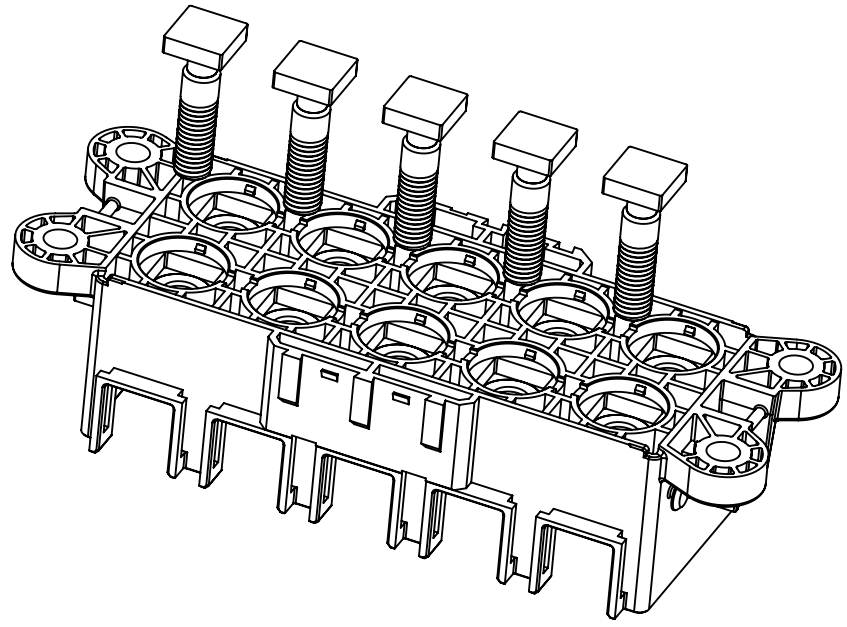

PUT 5PCS M10 STUD (908-077) INTO THE BOTTOM HOLE OF BASE (868-967)

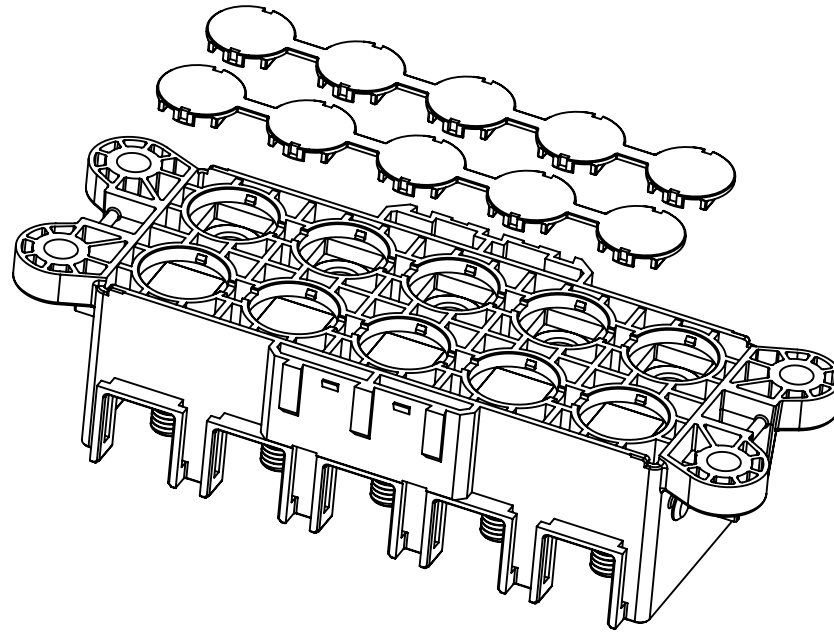

ASSEMBLY 2PCS BOTTOM CAP (883-094) ON BASE TO FIX STUDS

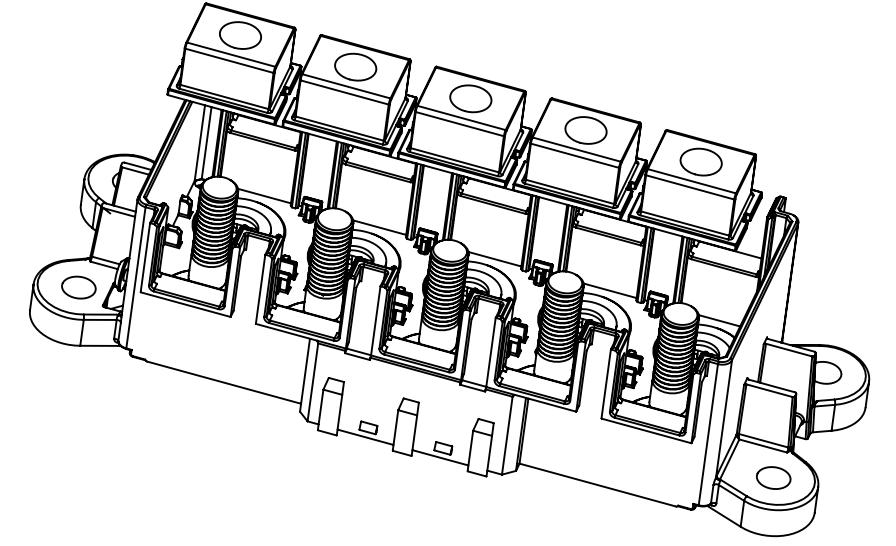

ASSEMBLY 5PCS SINGLE SUPPORT (901-722) ON BASE THROUGH STUDS

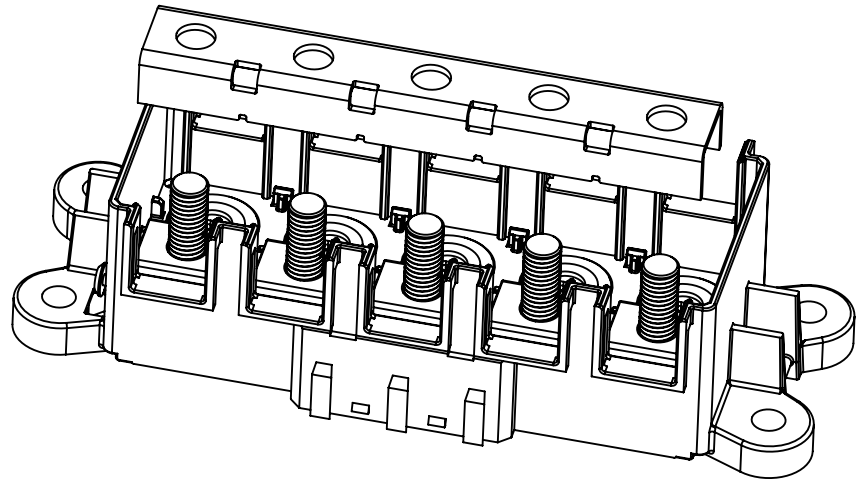

PUT 1PC U SHAPE BUS BAR (882-927-5) ON SUPPORT

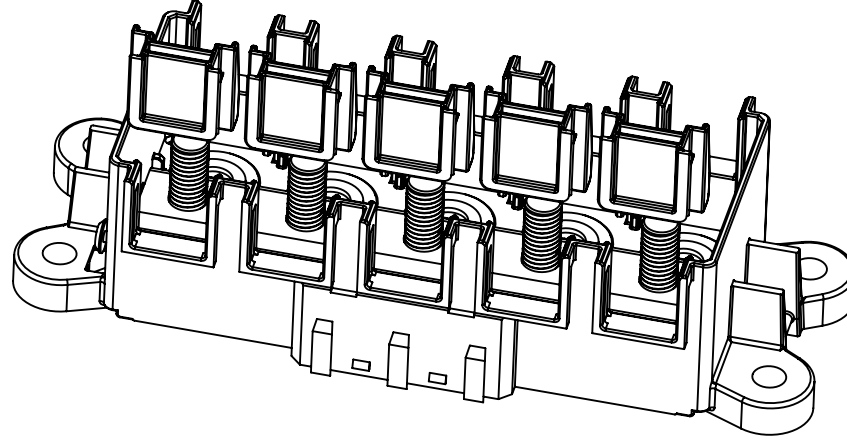

ASSEMBLY 5PCS DUST COVER (901-520) ON BASE

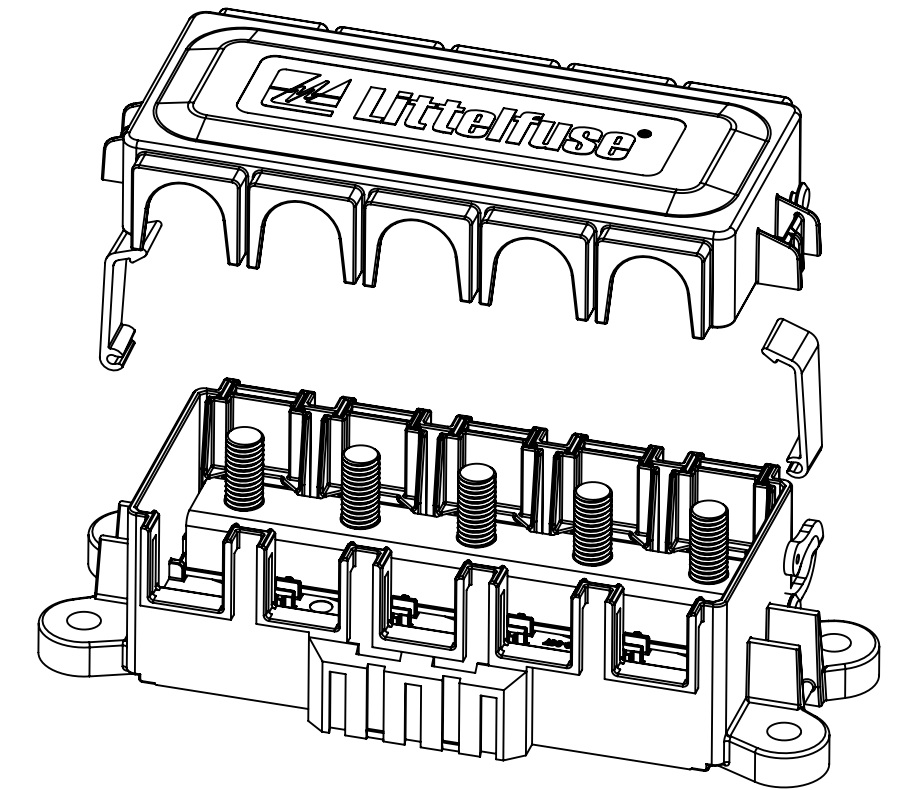

ASSEMBLY 2PCS LATCH (883-029), 1PC TETHER (890009470) AND 1 PC COVER (873-716) ON BASE

LIMIT DIMENSIONS OF PLASTIC MOLDED PARTS FOR NOMINAL SIZE RANGES PER ISO IN LITTELFUSE CVP-NPD20-0002, DIMENSIONS mm													
1 to 3	>3 to 6	>6 to 10	>10 to 18	>18 to 30	>30 to 50	>50 to 80	>80 to 120	>120 to 180	>180 to 250	>250 to 315	>315 to 400	ANGLE	
±0.08	±0.11	±0.14	±0.17	±0.20	±0.23	±0.36	±0.50	±0.58	±0.65	±0.70	±0.78	NONE	
SURFACE PROFILE DIMENSIONS OF PLASTIC MOLDED PARTS FOR NOMINAL SIZE RANGES PER ISO IN LITTELFUSE CVP-NPD20-0002, DIMENSIONS mm													
0.50	0.50	0.50	0.50	0.50	0.50	0.50	0.50	1.0	2.0	4.0	4.0		
DIMENSIONS ARE SHOWN IN MILLIMETERS. DIMENSIONS AND TOLERANCES ARE DEFINED ACCORDING TO ANSI/ASME Y14.5-1994.													
PER CH-NPD20-008 PROCEDURE	●	FIT/ FUNCTION CRITICAL CHARACTERISTICS											
	<S>	SAFETY/ COMPLIANCE CRITICAL CHARACTERISTICS SYMBOL											
	CPK	DENOTES CPK DIMENSIONS MINIMUM CPK VALUE											
	ST	DENOTES A CHARACTERISTIC THAT PROVIDES AN INDICATION OF PROCESS PERFORMANCE PROCEDURE FOR MEASUREMENT AND TRACKING TO BE DEFINED IN LITTELFUSE INSPECTION INSTRUCTIONS											
	CP	DENOTES CP DIMENSIONS, -MINIMUM CP VALUE MUST BE WITHIN THE DIMENSIONAL LIMITATIONS SHOWN ON DRAWING AND INITIALLY LOCATED TO ALLOW FOR MAXIMUM TOOL LIFE											
NAME		DATE		 Expertise Applied Answers Delivered								TITLE FHZ 5-STUD GROUND BOX	
DRAWN		DATE											
CHECKED		DATE											
FORM NO.		REV											
THIRD ANGLE PROJECTION													
DO NOT SCALE DRAWING		SCALE 1:2		SIZE C		DWG. NO.		FHZ1008Z		REV. B			
										SHEET 2 OF 2			