

# HAZGARD SERIES LIFT TRUCK FUSES

48 V • 35-800 A



## Description

HAZGARD fuses are designed to provide overcurrent protection for low voltage equipment used in hazardous operations. It is UL 248 recognized and has been evaluated for the use in UL 583 type EE and ES applications. Unique design does not require an additional enclosure as is needed with a standard forklift fuse, saving assembly time and costs.

## Features/Benefits

- Evaluated for use in UL 583 hazardous applications
- Easily upgrade Type E and ES equipment to Type EE
- Does not require an external enclosure

## Applications

Lift trucks, scissor lifts, pallet movers, and other low voltage battery operated equipment used to move hazardous materials.

## Dimensions mm (inches)

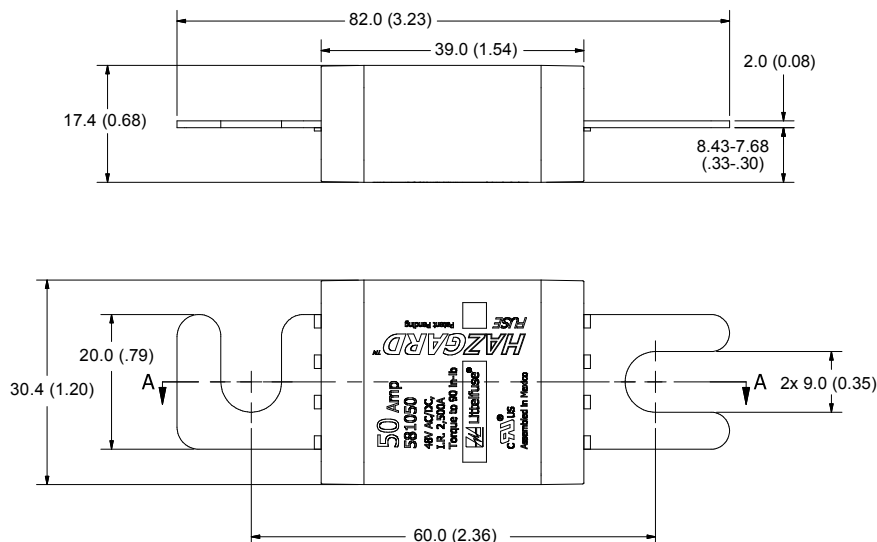

## Specifications

|                            |                              |
|----------------------------|------------------------------|
| <b>Voltage Ratings</b>     | 48 VAC/DC                    |
| <b>Interrupting Rating</b> | 2,500 A                      |
| <b>Ampere Rating</b>       | 10 – 800 A                   |
| <b>Approval</b>            | UL Recognized (File: E71611) |
| <b>Torque</b>              | 90 in-lb                     |
| <b>Fuse Holder</b>         | LFFB003                      |
| <b>Environmental</b>       | RoHS Compliant               |
| <b>Country of Origin</b>   | Mexico                       |

## Ordering Information

| SERIES | AMPERAGE | CATALOG NUMBER | ORDERING NUMBER |
|--------|----------|----------------|-----------------|
| 581    | 200      | 581200         | 0581200.X       |

| AMPERE RATINGS |     |     |      |
|----------------|-----|-----|------|
| 35             | 100 | 250 | 500  |
| 50             | 125 | 300 | 750* |
| 60             | 150 | 400 | 800* |
| 90             | 200 | 425 | —    |

\*Contact factory for availability

## Recommended Fuse Holders

LFFB0003Z

## Web Resources

[littelfuse.com/hazgard](http://littelfuse.com/hazgard)

**Disclaimer Notice** – Information furnished is believed to be accurate and reliable. However, users should independently evaluate the suitability of and test each product selected for their own applications. Littelfuse products are not designed for, and may not be used in, all applications. Read complete Disclaimer Notice at [www.littelfuse.com/product-disclaimer](http://www.littelfuse.com/product-disclaimer).