

REV.	DESCRIPTION	DATE	DESIGNED	APPROVED
A	FIRST ISSUE OF OUTLINE DRAWING	08-July_2020	Gasparini	Tinto

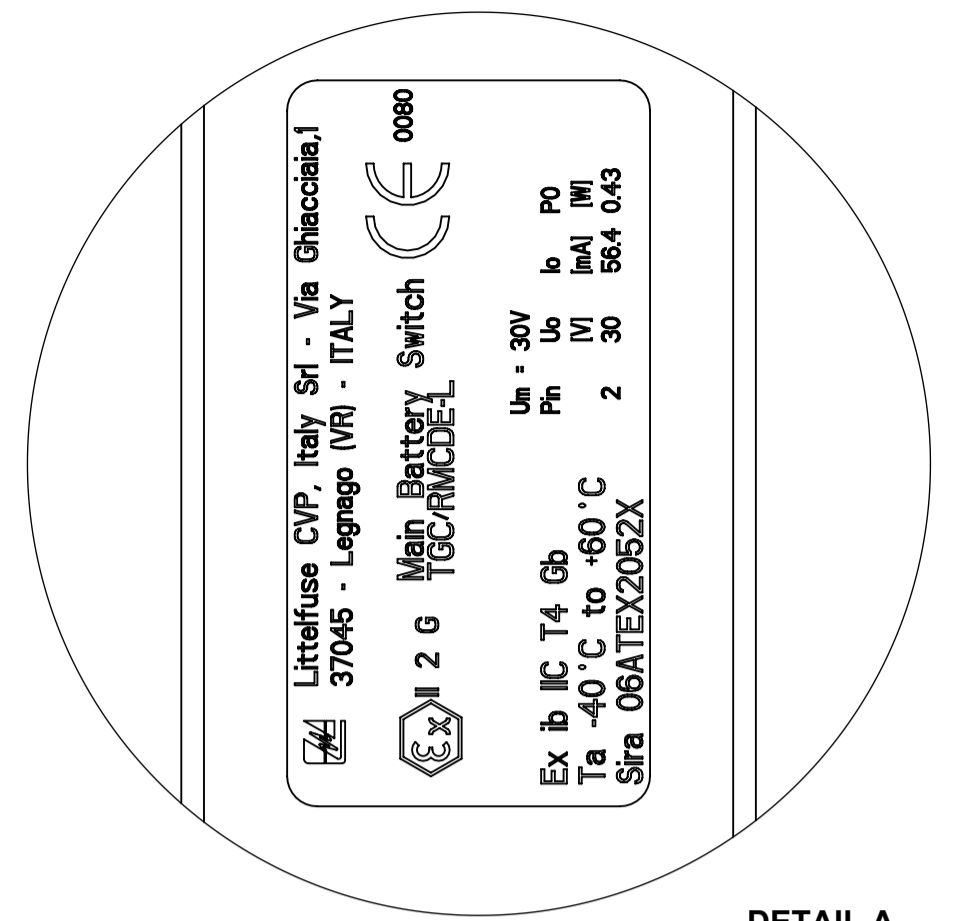

DETAIL A
SCALE 2 : 1

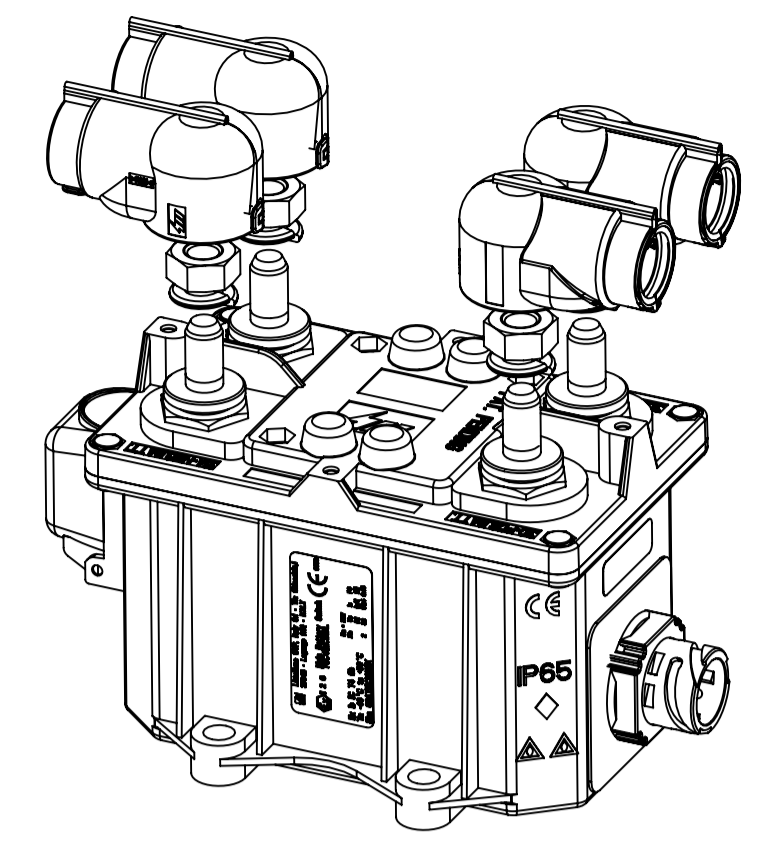
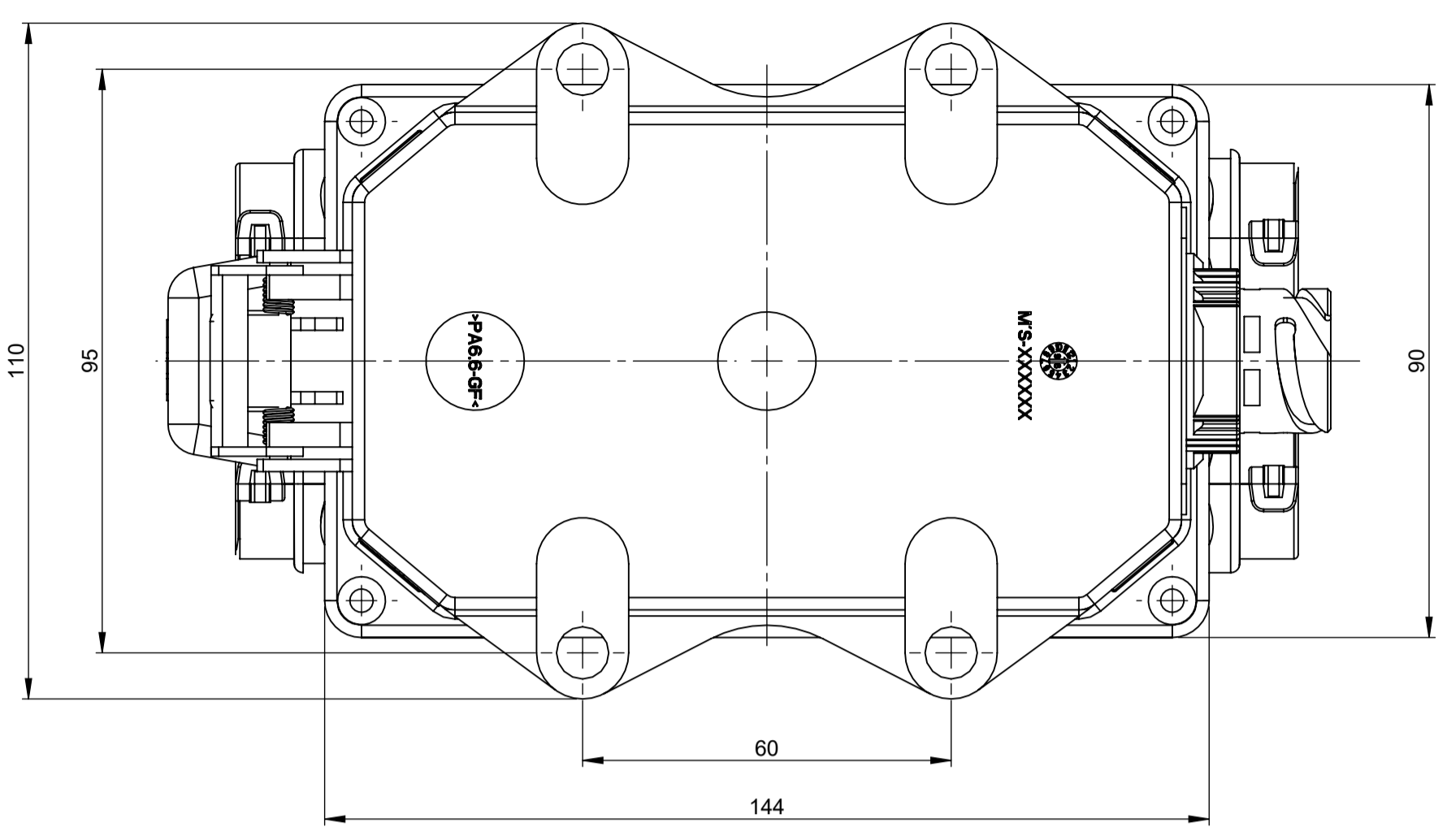

Spare part cod 00226200
Protection open 70mm

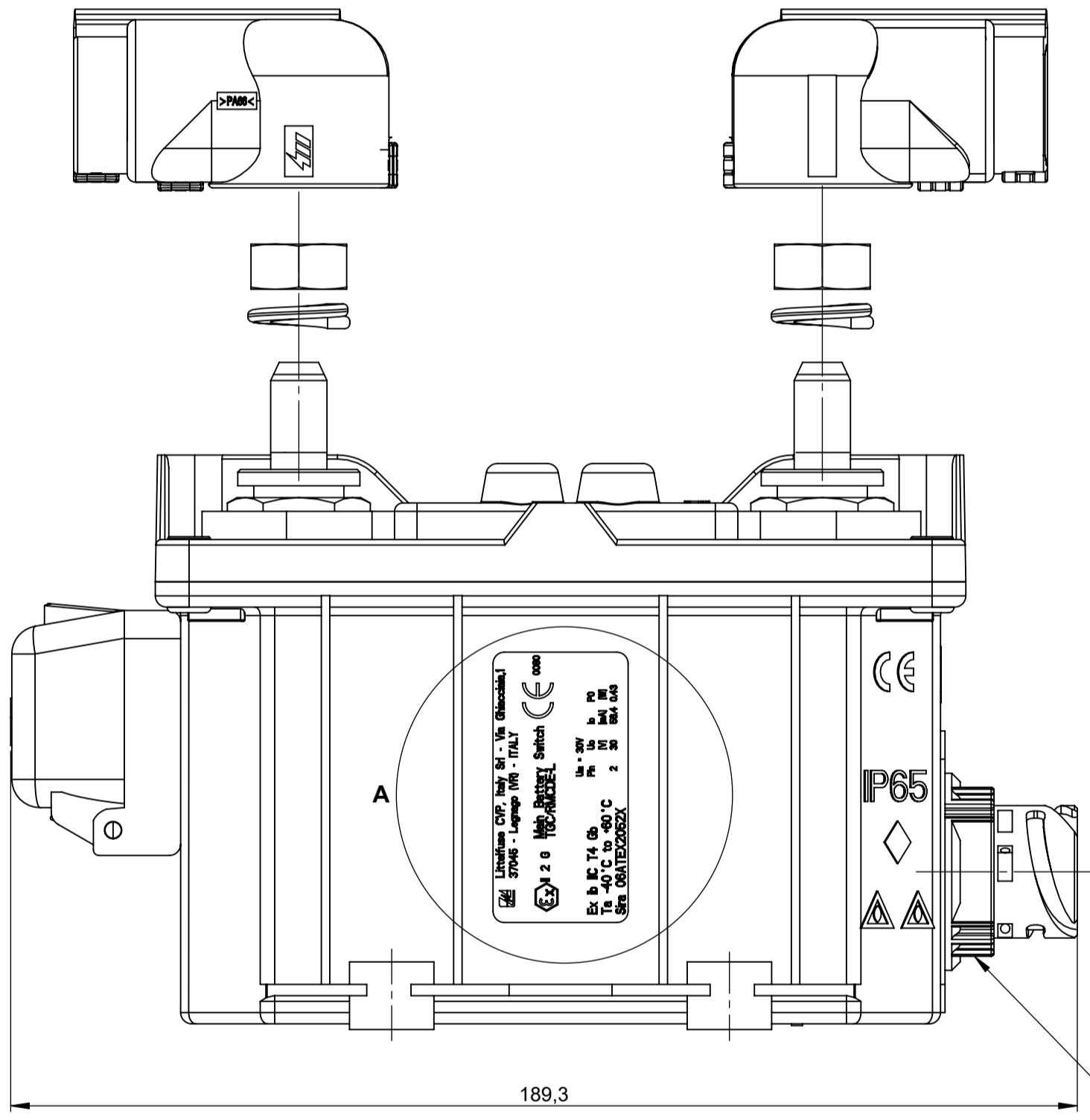
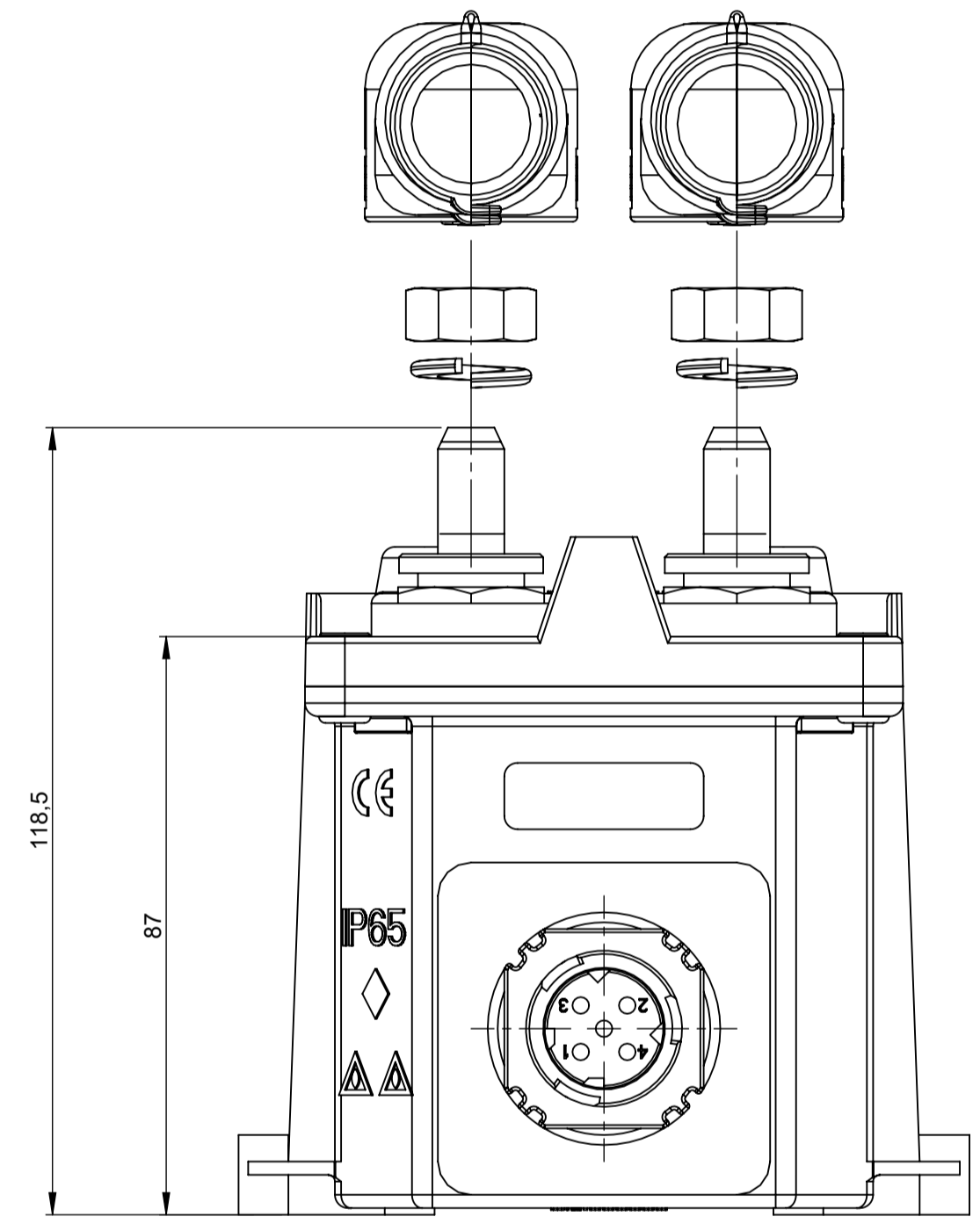

Screw the connector nut
with a pair of 7 ± 1 Nm

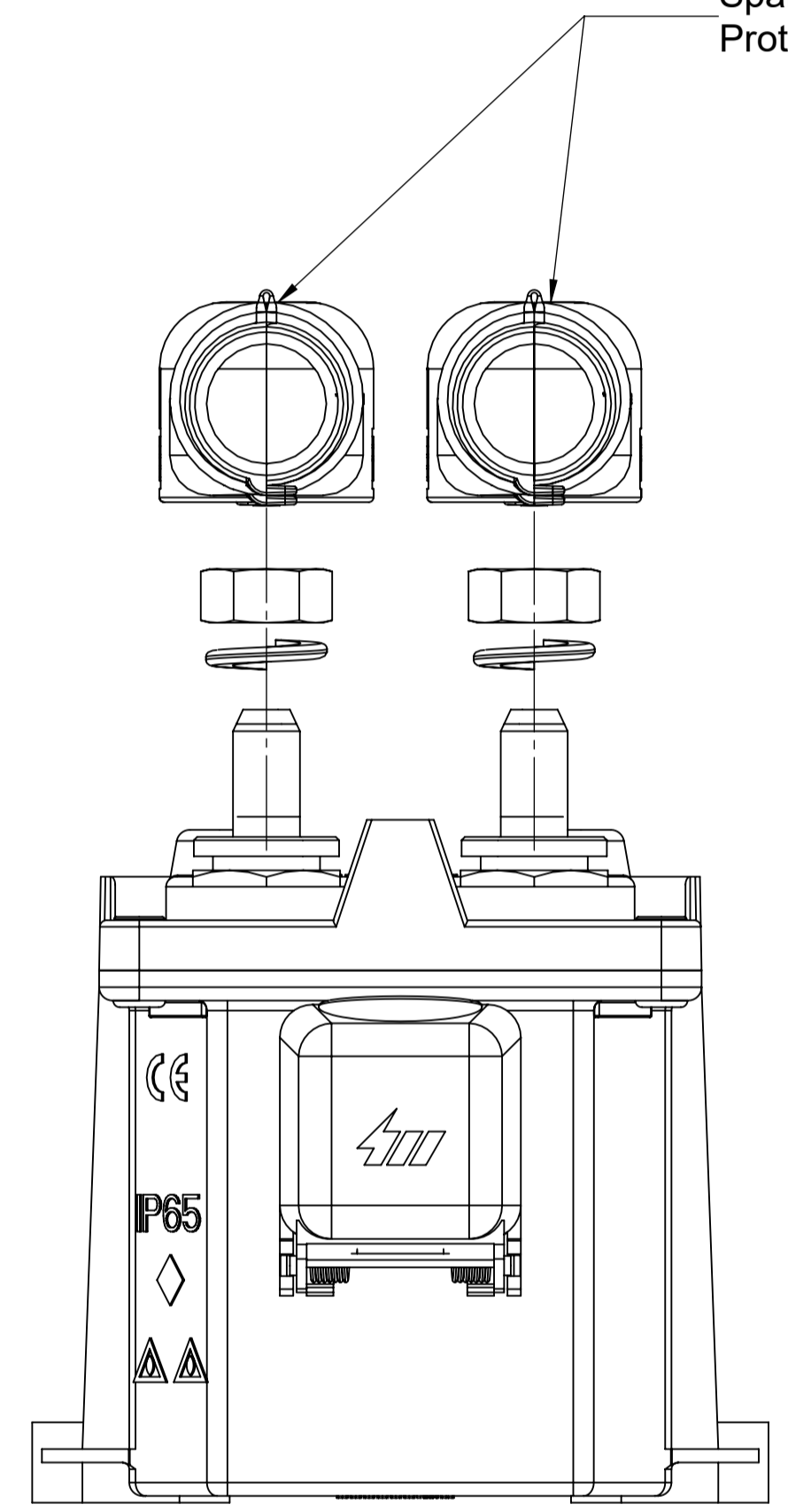

ELECTRICAL CHARACTERISTICS
 - Nominal operating voltage: 12 + 24 V
 - Max continuous current on contacts: 250 A at 23°C
 - Max current short duration on contacts: 2000 A at 23°C for 30 sec.

MECHANICAL CHARACTERISTICS
 - Number of electrical and mechanical operations: 50.000
 - Locking torque nuts M10/M12: 20 Nm

PRESCRIPTIONS
 - We suggest to fix the TGC to the structure by screws M8 UNI 5931:1984 and plane washers 8.4 x 17 UNI 6592:1969 under head
 - (*): Data of production
 - The distance between plunger bridge and fix contctas must be minimum 2 mm

SAP drawing number:
Material and treatments:

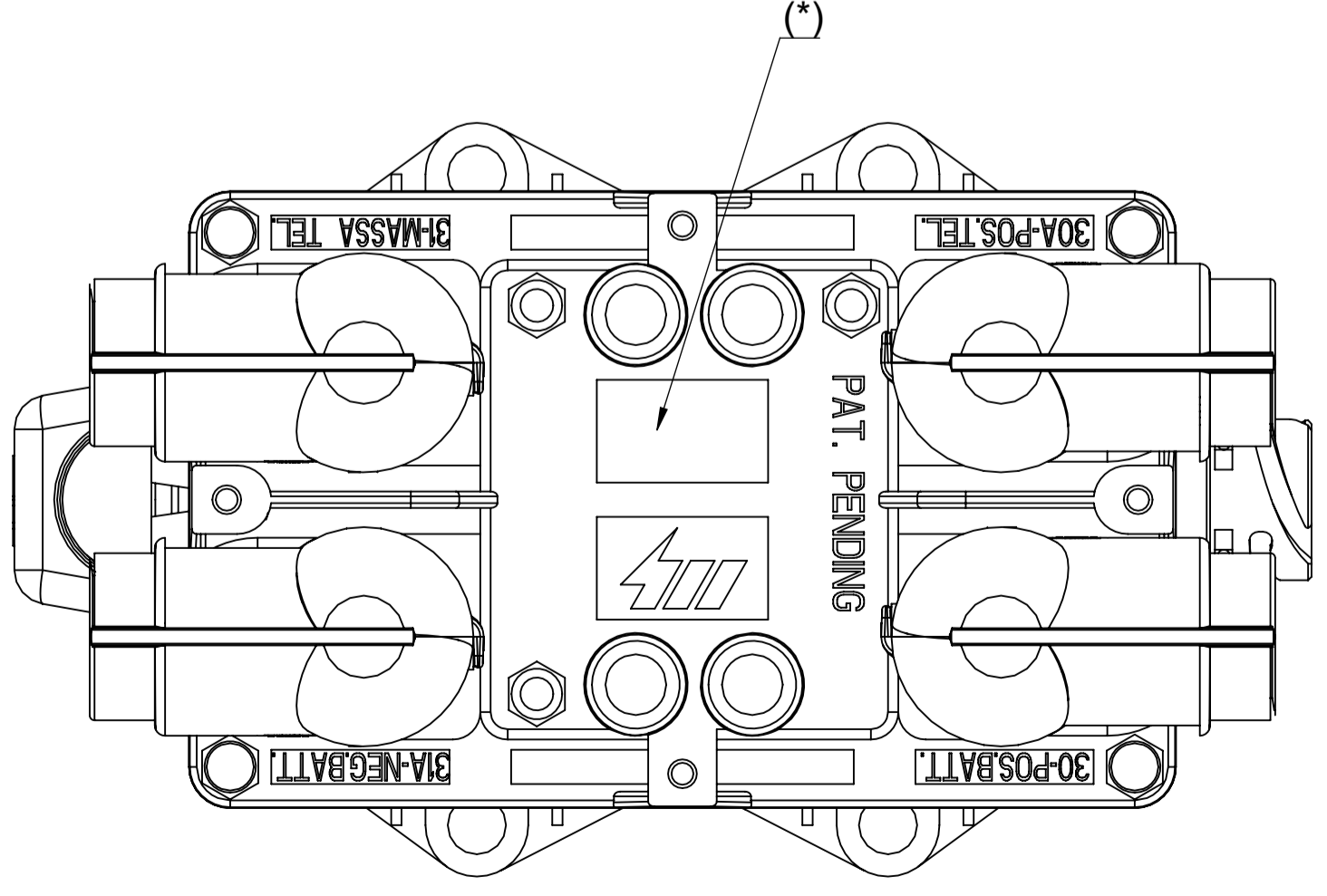

DIMENSIONS AND TOLERANCES IN MILLIMETERS, DEFINED ACCORDING TO ISO 1101:2017.						
linear dimensions						
0,5	>3	>6	>30	>120	>400	>1000
±0,2	±0,3	±0,5	±0,8	±1,2	±2	±3
angle (for range of lengths)						
up to 10	>10	>50	>120	>400	>1000	>2000
±1'30"	±1'	±0'30"	±0'15"	±0'15"	±0'15"	±0'15"
FIT: FUNCTION CRITICAL CHARACTERISTICS SYMBOL						
<S> SAFETY COMPLIANCE CRITICAL CHARACTERISTICS SYMBOL						
CPK DENOTES CPK DIMENSIONS MINIMUM CPK VALUE						
(ST) DENOTES A CHARACTERISTIC THAT PROVIDES AN INDICATION OF PROCESS PERFORMANCE PROCEDURE FOR MEASUREMENT AND TRACKING TO BE DEFINED IN LITTELFUSE INSPECTION INSTRUCTIONS						
CP DENOTES CP DIMENSIONS. MINIMUM CP VALUE MUST BE WITHIN THE DIMENSIONAL LIMITATIONS SHOWN ON DRAWING AND INITIALLY LOCATED TO ALLOW FOR MAXIMUM TOOL LIFE						
DRAWN	L. De Momi	DATE	27/05/2019	 Expertise Applied Answers Delivered		
CHECKED	-	-	-			
FORM NO.	CVP-RES-2019-REV.1	TITLE	GENERAL ELECTRICAL MAIN SWITCH	DO NOT SCALE DRAWING SCALE: A1 SHEET 1 OF 1		
FIRST ANGLE PROJECTION	SIZE: A1	REV.	01	OL-08097460		