

| REVISION | | |
|----------|----------|---|
| REV | DATE | DESCRIPTION |
| A | 10/13/22 | 525748GCP - RELEASE MRY |
| B | 11/8/22 | 525898ECP/D - CHANGE TOLERANCE & WIRE RANGE MRY |

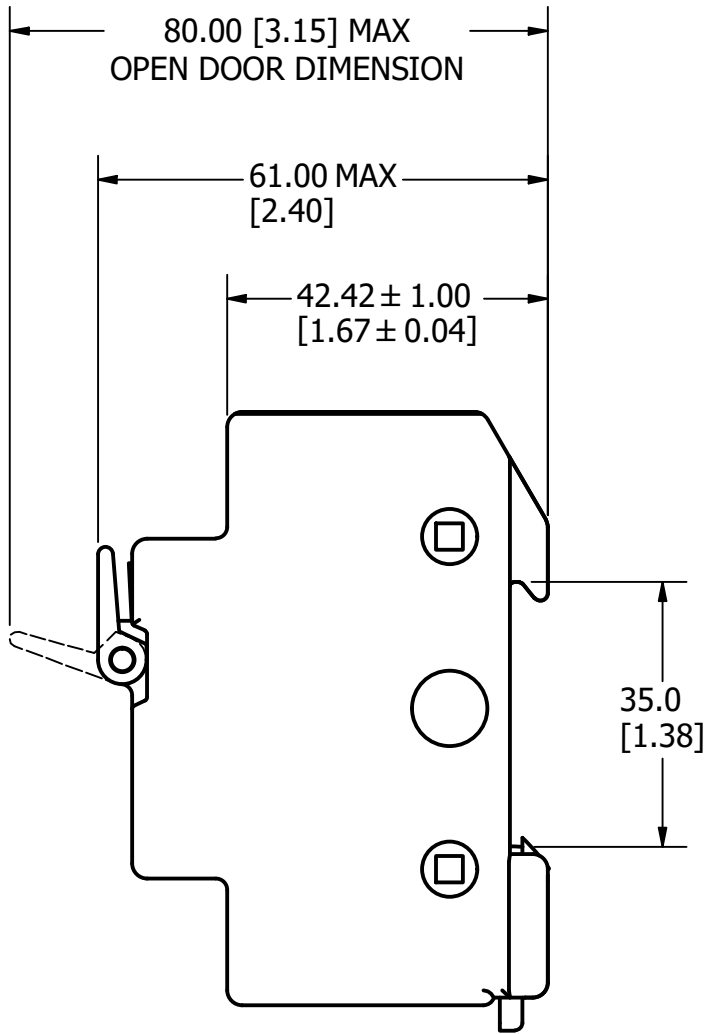
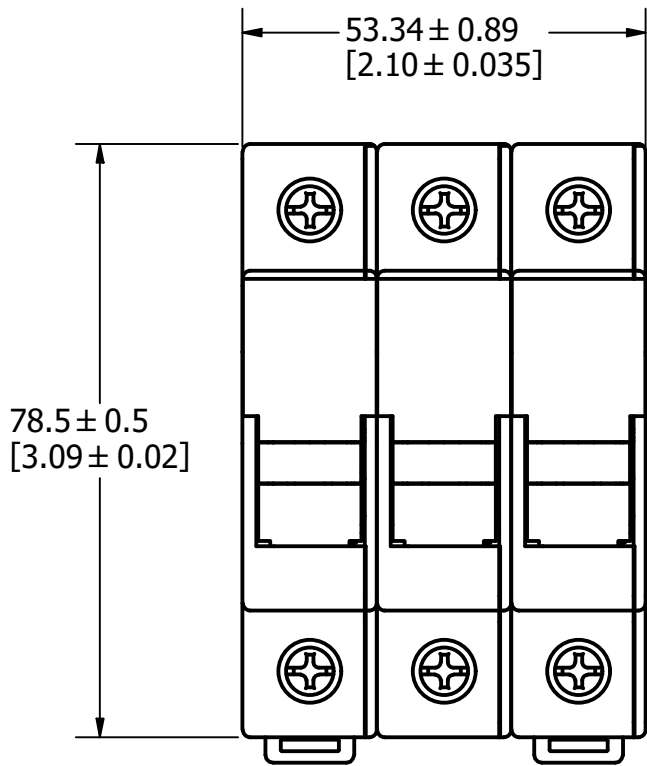

SPECIFICATIONS:

VOLTAGE RATING: 600V

AMP RATING: 30 AMPERES

INTERRUPT RATING: 200kA

WIRE RANGE: #8-14 AWG STRANDED Cu ONLY UL CLASS B & CLASS C WIRE
#10-14 AWG SOLID Cu ONLY

SUGGESTED TORQUE: 2 N-m [17.7 IN-LB]

APPROVALS: UL LISTED (FILE NO. E14721)
CSA CERTIFIED (FILE NO. LR7316)

| | | | | |
|---|--|----------------|---------------------|----------------------------|
| 1 | | | | |
| NO | COMPONENT NO | DESCRIPTION | QTY/M | U/M |
| BILL OF MATERIAL | | | | |
| <S> | CRITICAL CHARACTERISTIC FOR PART SAFETY/COMPLIANCE | | | |
| ● | DENOTES CRITICAL CHARACTERISTICS. | | | |
| CPK | DENOTES CPK DIMENSIONS, -MINIMUM CPK VALUE | | | |
| ST | DENOTES A CHARACTERISTIC THAT PROVIDES AN INDICATION OF PROCESS PERFORMANCE. PROCEDURE FOR MEASUREMENT AND TRACKING TO BE DEFINED IN LITTELFUSE INSPECTION INSTRUCTIONS. | | | |
| CP | DENOTES CP DIMENSIONS, -MINIMUM CP VALUE MUST BE WITHIN THE DIMENSIONAL LIMITATIONS SHOWN ON DRAWING AND INITIALLY LOCATED TO ALLOW FOR MAXIMUM TOOL LIFE. | | | B |
| MATL SPEC | | FINISH | | |
| DRW JMOLER | | DATE 10/5/2022 | SCALE NTS | FINISH GOOD WT GRAMS/PIECE |
| UNLESS OTHERWISE SPECIFIED, DIMENSIONS ARE IN MILLIMETERS, DIMENSIONS IN BRACKETS [] ARE INCHES DIMENSIONING AND DO NOT INCLUDE PLATING. TOLERANCING TO BE INTERPRETED IN ACCORDANCE WITH ANSI Y14.5M-1994 | | | | |
| 3RD ANGLE PROJECTION | | | | |
| TITLE LPSC003 OUTLINE | | | | |
| Littelfuse® CHICAGO, ILLINOIS 60631 | | REVISION B | DRWG NO. OL-LPSC003 | SHEET 1 OF 1 |