

Ø50.80
[Ø2.000]

6.35 ± 0.08
[0.250 ± 0.003]

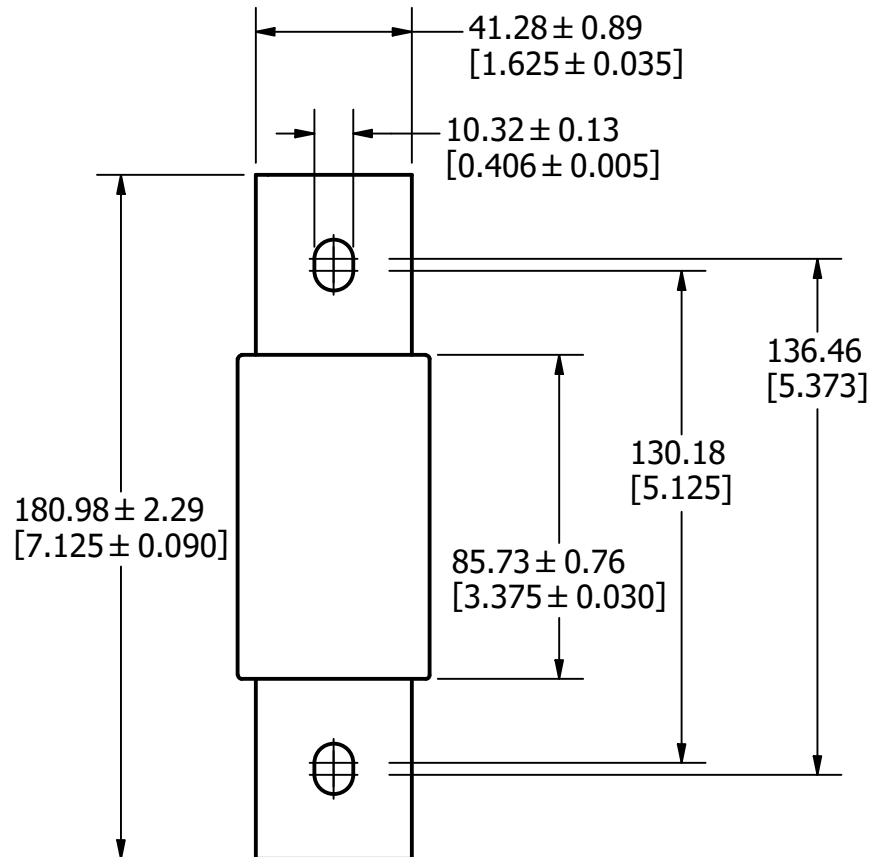

REVISION

REV	DATE	DESCRIPTION
A	6/21/22	525355GCP - RELEASE MRY

APPROX. SHIPPING WEIGHT: 1 FUSE = 1.7 LB

1	NO	COMPONENT NO	DESCRIPTION	QTY/M	U/M
---	----	--------------	-------------	-------	-----

BILL OF MATERIAL

<S>	CRITICAL CHARACTERISTIC FOR PART SAFETY/COMPLIANCE
●	DENOTES CRITICAL CHARACTERISTICS.
CPK	DENOTES CPK DIMENSIONS, -MINIMUM CPK VALUE
ST	DENOTES A CHARACTERISTIC THAT PROVIDES AN INDICATION OF PROCESS PERFORMANCE. PROCEDURE FOR MEASUREMENT AND TRACKING TO BE DEFINED IN LITTELFUSE INSPECTION INSTRUCTIONS.
CP	DENOTES CP DIMENSIONS, -MINIMUM CP VALUE MUST BE WITHIN THE DIMENSIONAL LIMITATIONS SHOWN ON DRAWING AND INITIALLY LOCATED TO ALLOW FOR MAXIMUM TOOL LIFE.

MATL SPEC	FINISH
-----------	--------

DRW Jeff Moler	DATE 6/16/2022	SCALE NTS	FINISH GOOD WT GRAMS/PIECE
-------------------	-------------------	--------------	-------------------------------

UNLESS OTHERWISE SPECIFIED, DIMENSIONS ARE IN MILLIMETERS, DIMENSIONS IN BRACKETS [] ARE INCHES DIMENSIONING AND DO NOT INCLUDE PLATING. TOLERANCING TO BE INTERPRETED IN ACCORDANCE WITH ANSI Y14.5M-1994

3RD ANGLE
PROJECTION

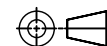

TITLE JLS 225-400A OUTLINE



REVISION	DRWG NO.	SHEET 1 OF 1
A	OL-0JLS400	