

SECTION B - B

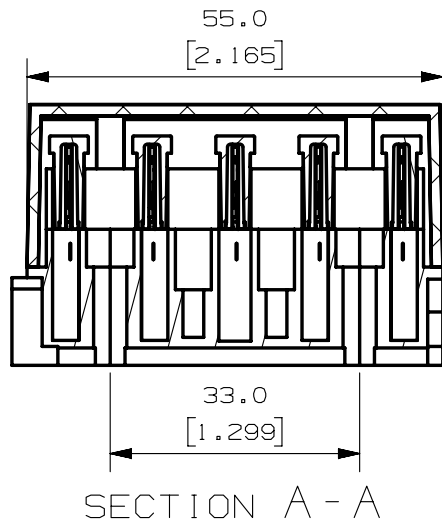

SECTION A - A

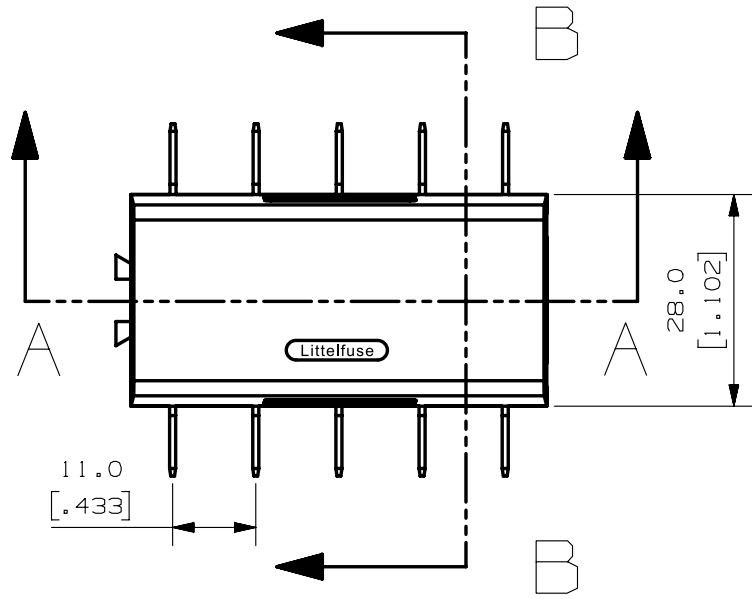
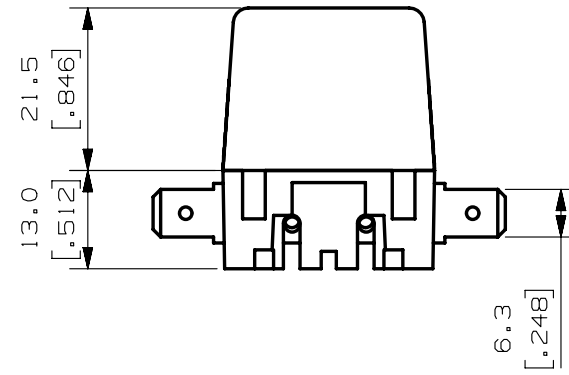

METRIC
ASSEMBLY

- NOTES:
 1. MATERIALS:
 COVER: CRYSTAL-CLAEER POLYCARBONATE
 BODY: BLACK POLYAMIDE, GLASS FIBER REINFORCED
 CONTACT SECURING: WHITE POLYAMIDE, GLASS FIBER REINFORCED
 CONTACTS: TIN PLATED BRASS, PLATING THICKNESS 8-10u

NO	COMPONENT NO	DESCRIPTION	QTY/M	U/M
BILL OF MATERIAL				
		UNLESS OTHERWISE SPECIFIED, DIMENSIONS ARE IN MILLIMETERS. DIMENSIONS IN BRACKETS [] ARE INCHES		
		UNLESS OTHERWISE SPECIFIED, DIMENSIONS DO NOT INCLUDE PLATING.		
		⊙ DENOTES CRITICAL CHARACTERISTICS.		
		CPK DENOTES CPK DIMENSIONS, -MINIMUM CPK VALUE		
		ST DENOTES A CHARACTERISTIC THAT PROVIDES AN INDICATION OF PROCESS PERFORMANCE. PROCEDURE FOR MEASUREMENT AND TRACKING TO BE DEFINED IN LITTELFUSE INSPECTION INSTRUCTIONS		
		CP DENOTES CP DIMENSIONS, -MINIMUM CP VALUE MUST BE WITHIN THE DIMENSIONAL LIMITATIONS SHOWN ON DRAWING AND INITIALLY LOCATED TO ALLOW FOR MAXIMUM TOOL LIFE		

LTR	DATE	REVISION	CHK	APD
A	5/Jan/16	515377GCA-RELEASE FYUE		

COPIES TO	MATL SPEC	REFER TO NOTES
1 9 18		
2 10 19	FINISH	REFER TO NOTES
3 12 20		
4 13 21	DRW DATE 8/16/13	SCALE 1:1
5 14 23	FYUE	SUPER DR
6 15 33	CHK	
7 16 43	APPD	FINISH GOOD WT
8 17 53		GRAMS/PIECE

TOLERANCES UNLESS OTHERWISE SPECIFIED (REF. ISO 2768-FH)	UP TO 0.5	UP TO 3	UP TO 6	UP TO 30	UP TO 120	UP TO 400
DIMENSION	±0.1	±0.1	±0.2	±0.3	±0.5	±0.5
TOLERANCE						

3RD ANGLE PROJECTION	TITLE	REVISION	DRWG. NO.	OUTLINE
	ATO BLOCK 5 POSITIONS, HORIZONTAL CONTACTS		A	03500417Z

Littelfuse
 LIPA CITY, BATANGAS, PHILIPPINES