

REVISION		
REV	DATE	DESCRIPTION
A	6/12/2015	514461GCF - RELEASED -TV
B	12/18/2015	515356ECP - ADD ISO VIEW/ REMOVE LOGO -TV

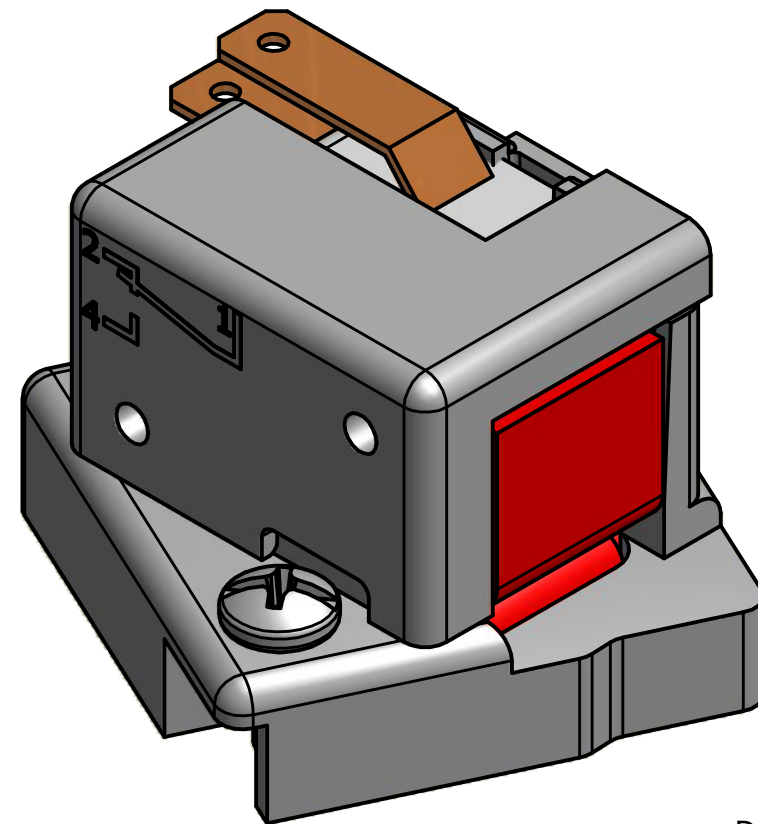
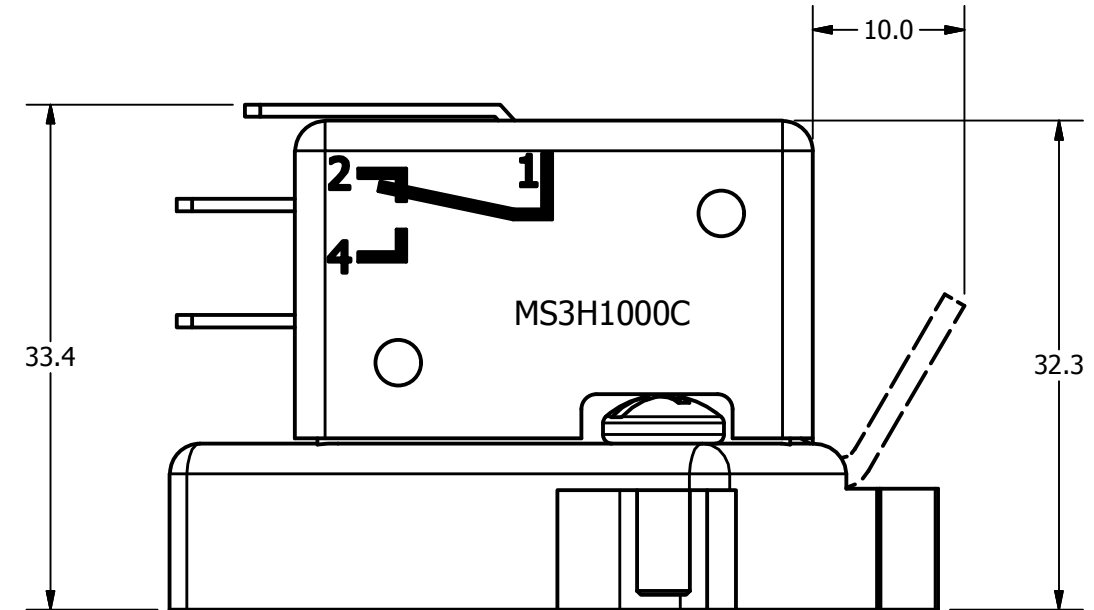
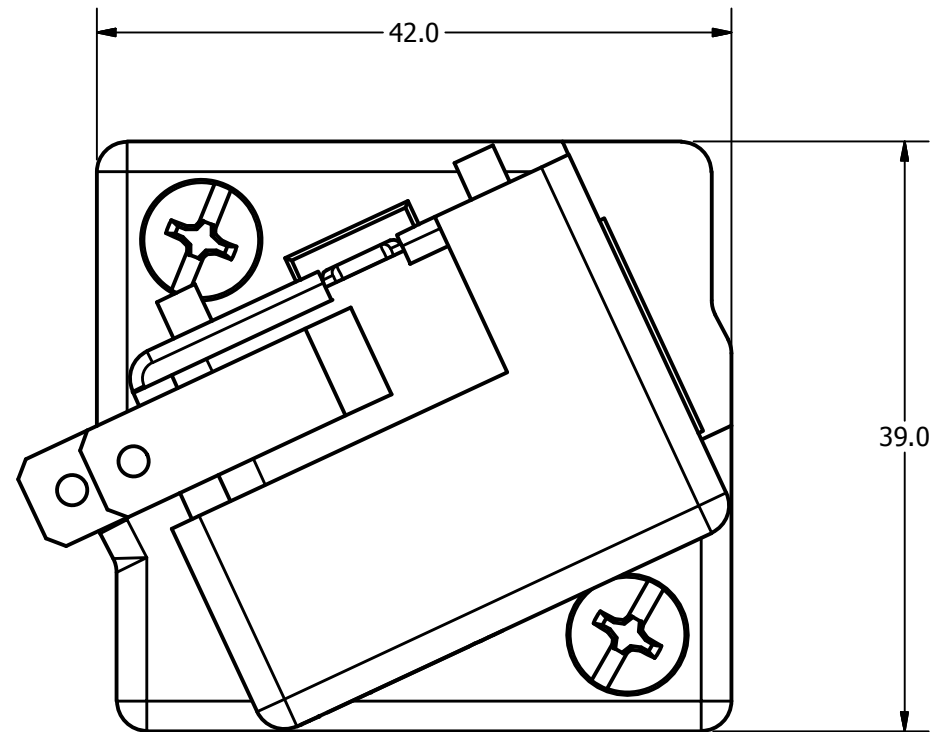

DATA SHEET REVISION: 121815

●	DENOTES CRITICAL CHARACTERISTICS.
CPK	DENOTES CPK DIMENSIONS, -MINIMUM CPK VALUE
⬡	DENOTES A CHARACTERISTIC THAT PROVIDES AN INDICATION OF PROCESS PERFORMANCE. PROCEDURE FOR MEASUREMENT AND TRACKING TO BE DEFINED IN LITTELFUSE INSPECTION INSTRUCTIONS.
CP	DENOTES CP DIMENSIONS, -MINIMUM CP VALUE MUST BE WITHIN THE DIMENSIONAL LIMITATIONS SHOWN ON DRAWING AND INITIALLY LOCATED TO ALLOW FOR MAXIMUM TOOL LIFE.

B

MATL SPEC		FINISH	
DRW TVESELSK	DATE 1/7/2015	SCALE NTS	FINISH GOOD WT GRAMS/PIECE

UNLESS OTHERWISE SPECIFIED, DIMENSIONS ARE IN MILLIMETERS, DIMENSIONS IN BRACKETS [] ARE INCHES DIMENSIONING AND DO NOT INCLUDE PLATING. TOLERANCING TO BE INTERPRETED IN ACCORDANCE WITH ANSI Y14.5M-1994

3RD ANGLE PROJECTION	
----------------------	--

TITLE	MICROSWITCH OUTLINE
-------	---------------------

Littelfuse CHICAGO, ILLINOIS 60631	REVISION B	DRWG NO. OL-MS3H1000C	SHEET 1 OF 1
--	----------------------	---------------------------------	--------------